

Go Traffic Management

This drawing has been produced for a specific client & project identified below and is not intended for use by any other person or for any other purpose. © Go Traffic Management

- Risks**
- Design completed from information provided + google maps desktop risk assessment
 - Cone lamps must be used on all road with A speed limit of 40mph or more.

- Notes**
- All signs as per Chapter 8. Distances between cones to be 9m maximum unless otherwise noted.
 - Distances between signs NOT to scale for purpose of clarity.
 - All sign placement subject to available safe working space.
 - The purpose of the Traffic Management Plan is for it to be used only as a guide and all traffic management equipment should be put out according to the 'Safety at Street Works and Road Works - Code of Practice', i.e. Red Book & the 'Traffic Signs Manual Chapter 8', i.e. Yellow Book.
 - Signs must be placed in accordance with TSM and the scheme RAMS pack.
 - Site conditions may have changed since the design of the drawing any changes which subsequently affect the design need to be reported by the Traffic Management Operative & any changes implemented must comply with Chapter 9.

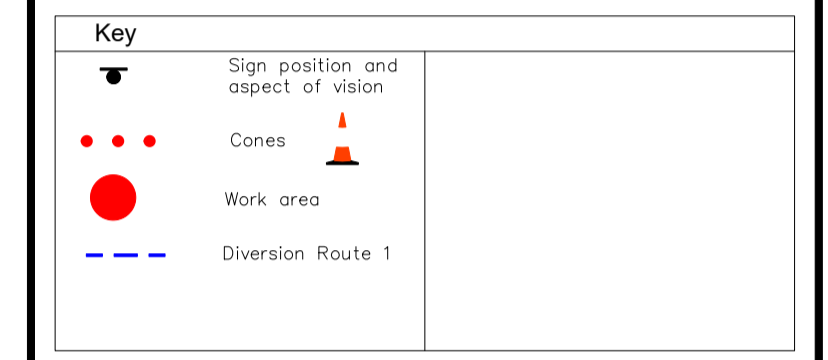

WRITTEN DIVERSION ROUTE:
Faulkner Rd <- Castle Ln

Traffic Management must comply with The Safety at Street Works and Road Works Code of Practice

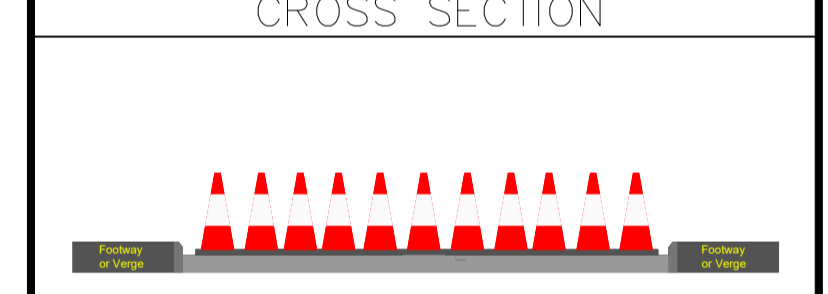

DO NOT SCALE FROM THIS DRAWING		ROAD CLOSURE
A	18.12.23	AS DRAWN
REV.	DATE	DESCRIPTION

GTM
Go Traffic Management

Head Office: Go Traffic Management,
Chaddock Lane, Worsley, Manchester, M28 1XW
Tel: 0161 351 5370
www.gtm.co.uk

TRAFFIC MANAGEMENT PLAN

Client: **SEVERN TRENT WATER**

Drawing Number: 851532
Drawing Title: RODNEY ROAD ELMDON B92 8SB

Design:	Technical Officer:	REV:
Name: C.R	J.McNamara	A
Signature:		
Date: 18.12.23	18.12.23	