

FORDBRIDGE

NOTES:

1. All signs and cones to be in accordance with Chapter 8 new roads and street works a code of practice (Red book)
2. Works access and egress are indicative, exact locations to be agreed on site.
3. Safety zones are to be installed as required as shown by the SAFETY ZONE DIMENSIONS BELOW
4. All signs to be located so as not to obscure signs or objects and should be ballasted near to ground level using sand filled hessian bags or sign straps.
5. All sign positions are indicative only and must be accurately positioned on site with good visibility and be clear of and obstructions or vegetation at all times.
6. Drawing not to scale



cadrequest@sus.co.uk tmbookings@sus.co.uk

NOTES:

Traffic sign Diversion
 Cone
 Work Area WORKS ACCESS WORKS EXIT
 Safety Zone Works access/works exit to be risk assessed on site for suitability of location

TRAFFIC MANAGEMENT NOTES

SPEED OF ROAD:

LONGWAYS: 0.5m
SIDEWAYS: 0.5m



A		A	
B		B	
C		C	
D		D	

CLIENT:



SITE:
66 Sheepclose Dr, Fordbridge, Birmingham B37 5DJ
GRID REF: -----

TITLE: FOOTPATH CLOSURE

SCALE AT 13: NTS	DATE:	DRAWN: JORDAN.C	CHECKED: JACK . B
DWG NO: WMGA240248 03	REV NO:	001	

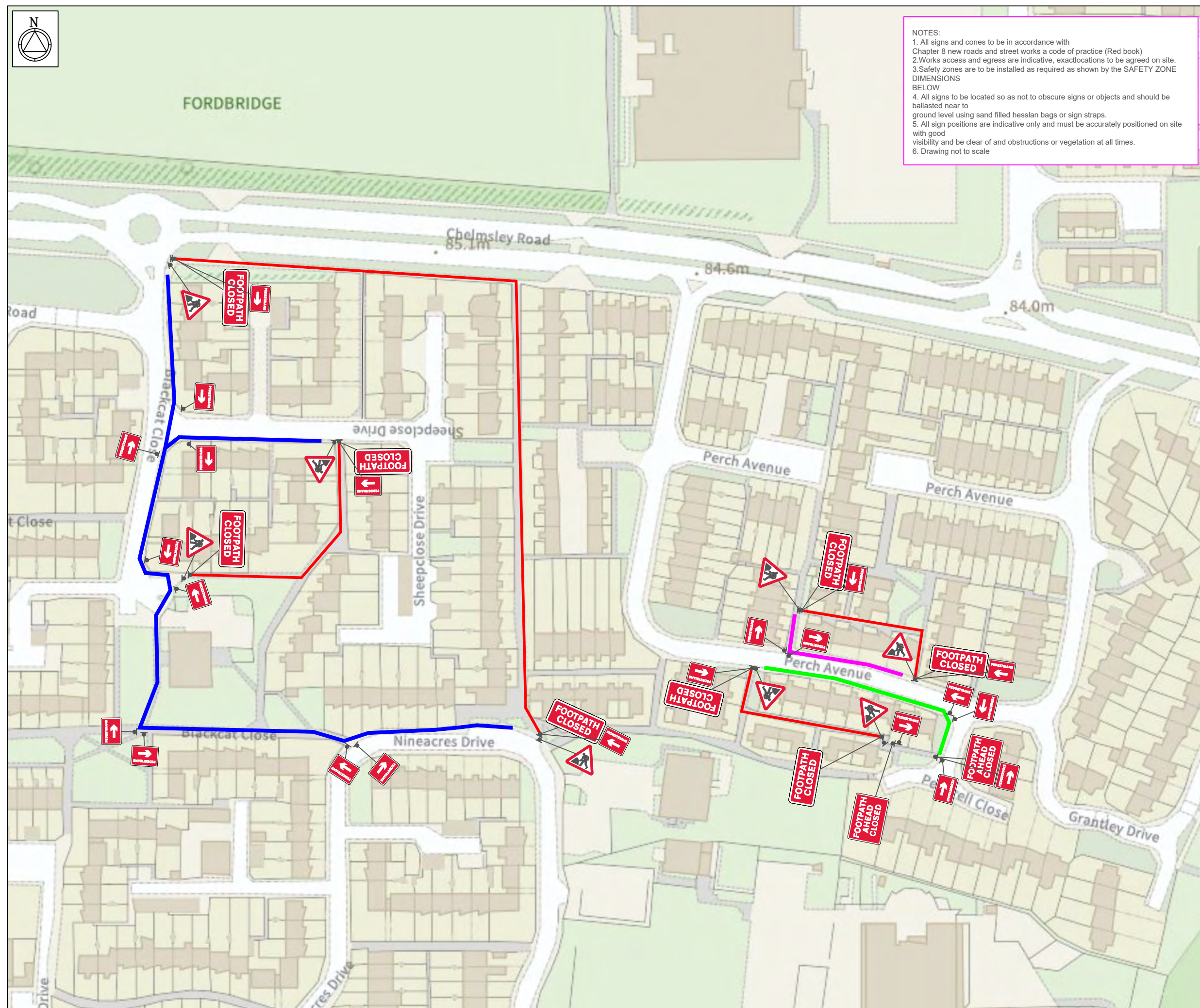

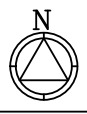

NOTES:
 1. All signs and cones to be in accordance with Chapter 8 new roads and street works a code of practice (Red book)
 2. Works access and egress are indicative, exact locations to be agreed on site.
 3. Safety zones are to be installed as required as shown by the SAFETY ZONE DIMENSIONS BELOW
 4. All signs to be located so as not to obscure signs or objects and should be ballasted near to ground level using sand filled hessian bags or sign straps.
 5. All sign positions are indicative only and must be accurately positioned on site with good visibility and be clear of and obstructions or vegetation at all times.
 6. Drawing not to scale



cadrequest@sus.co.uk tmbookings@sus.co.uk

NOTES:

Traffic sign
 Cone
 Work Area
 Safety Zone
 Diversion
 WORKS ACCESS
 WORKS EXIT
Works access/works exit to be risk assessed on site for suitability of location

TRAFFIC MANAGEMENT NOTES

SPEED OF ROAD:
 LONGWAYS: 0.5m
 SIDEWAYS: 0.5m



A		A	
B		B	
C		C	
D		D	

CLIENT:



SITE:
 261 Bosworth Dr, Fordbridge, Birmingham B37 5DN
 GRID REF: -----

TITLE: ROAD CLOSURE

SCALE AT 13: NTS	DATE:	DRAWN: JORDAN.C	CHECKED: JACK . B
DWG NO: WMGA240248 05	REV NO:	001	

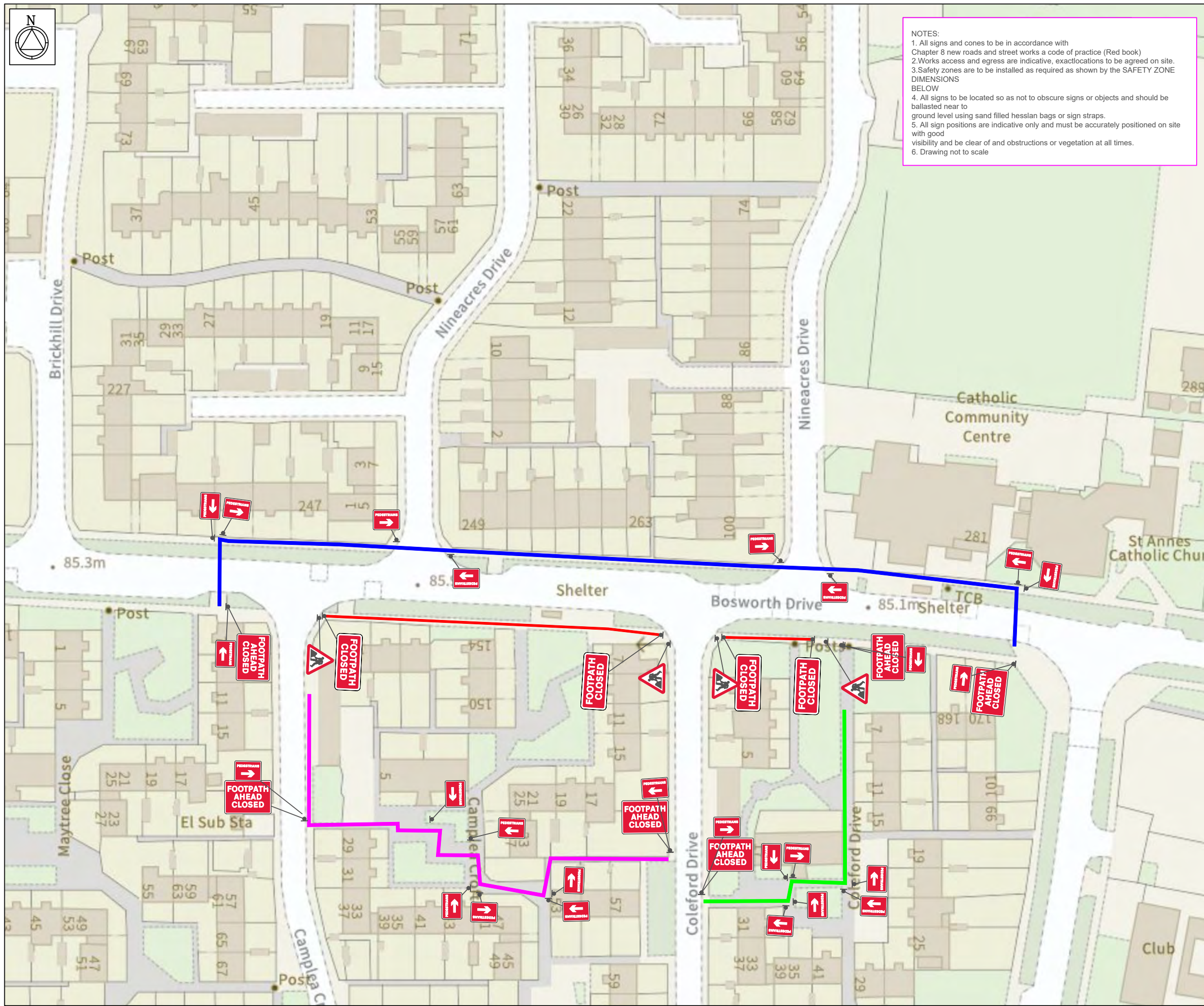



NOTES:
 1. All signs and cones to be in accordance with Chapter 8 new roads and street works a code of practice (Red book)
 2. Works access and egress are indicative, exact locations to be agreed on site.
 3. Safety zones are to be installed as required as shown by the SAFETY ZONE DIMENSIONS BELOW
 4. All signs to be located so as not to obscure signs or objects and should be ballasted near to ground level using sand filled hessian bags or sign straps.
 5. All sign positions are indicative only and must be accurately positioned on site with good visibility and be clear of and obstructions or vegetation at all times.
 6. Drawing not to scale

NOTES:

Traffic sign
 Cone
 Work Area
 Safety Zone
 Diversion
 WORKS ACCESS
 WORKS EXIT
Works access/works exit to be risk assessed on site for suitability of location

TRAFFIC MANAGEMENT NOTES

SPEED OF ROAD:		
LONGWAYS:	0.5m	
SIDEWAYS:	0.5m	

A		A	
B		B	
C		C	
D		D	

CLIENT:



SITE:
9 Brickhill Dr, Fordbridge, Birmingham B37 5BY

GRID REF: -----

TITLE: FOOTPATH CLOSURE

SCALE AT 13: NTS	DATE:	DRAWN: JORDAN.C	CHECKED: JACK . B
---------------------	-------	--------------------	----------------------

DWG NO: WMGA240248 04	REV NO: 001
--------------------------	----------------

