

ISO A1 594mm x 841mm
 Approved: MD
 Checker: AB
 Designer: CB
 Project Management Initials:
 Highway Services 4 - Schemes Projects 08 - P24P23-028 - H2/26SP - Water Orton Road - Design 02 -
 Location & Proposals DWG
 Date Issued: 16/05/24
 File Name: C:\Users\Jack.Burke\OneDrive - Solihull Council\Documents - Highway Services 4 - Schemes Projects 08 - P24P23-028 - H2/26SP - Water Orton Road - Design 02 - Location & Proposals DWG

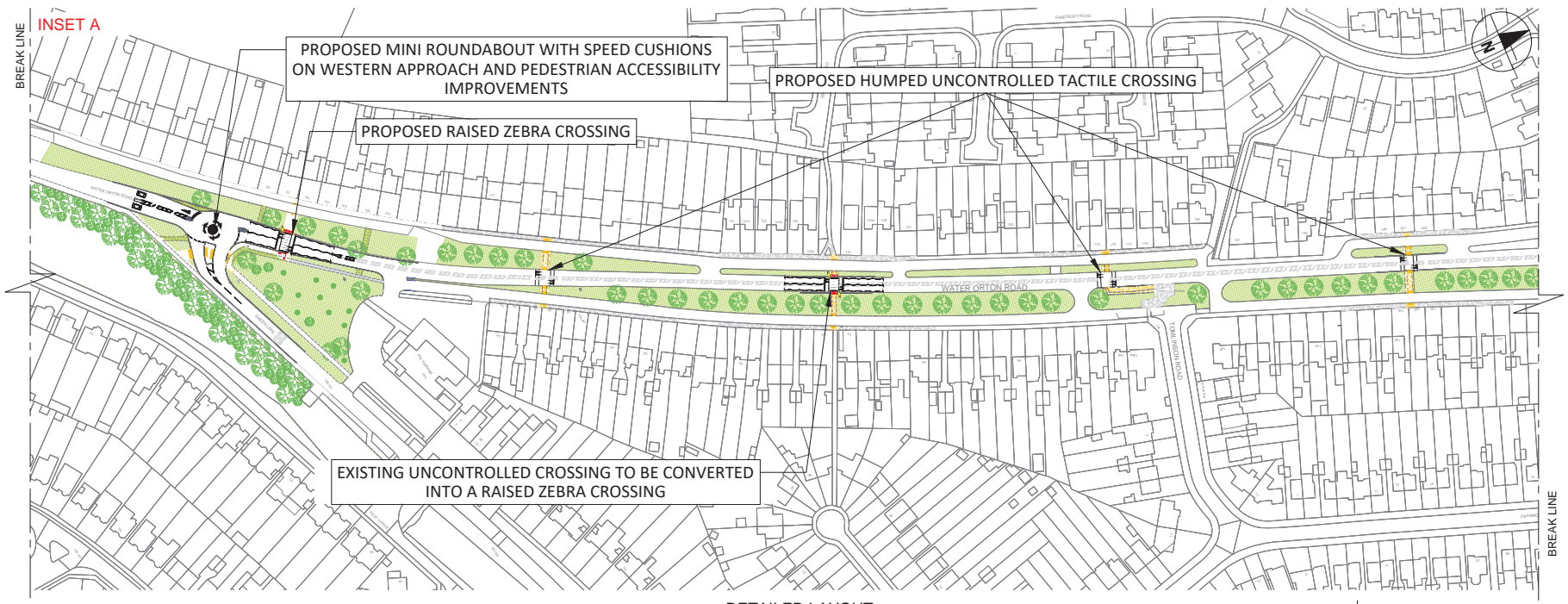

DETAILED LAYOUT
SCALE (1:1000)

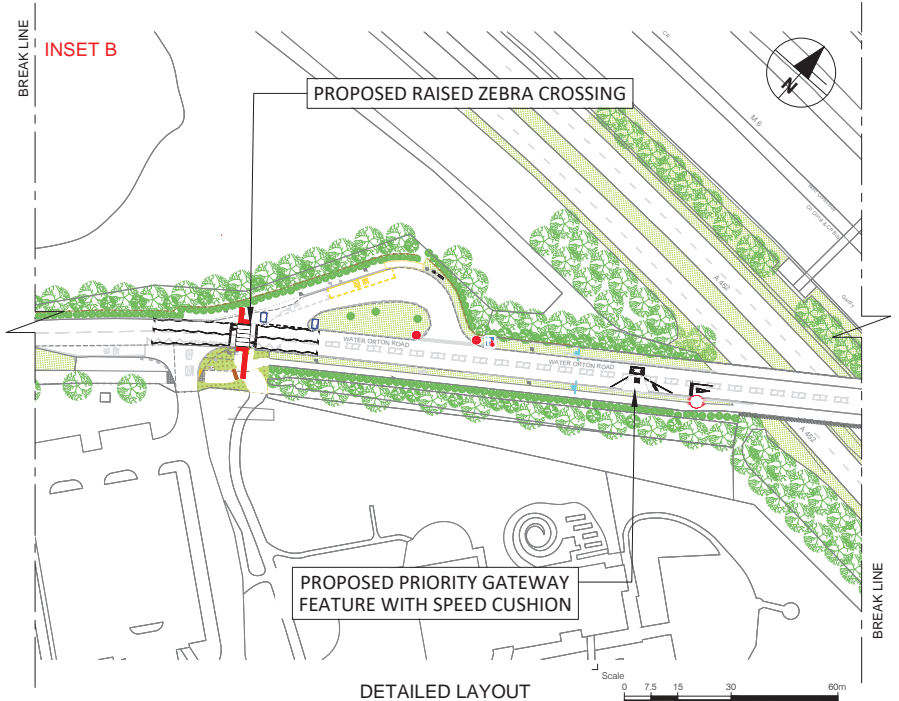

DETAILED LAYOUT
SCALE (1:750)

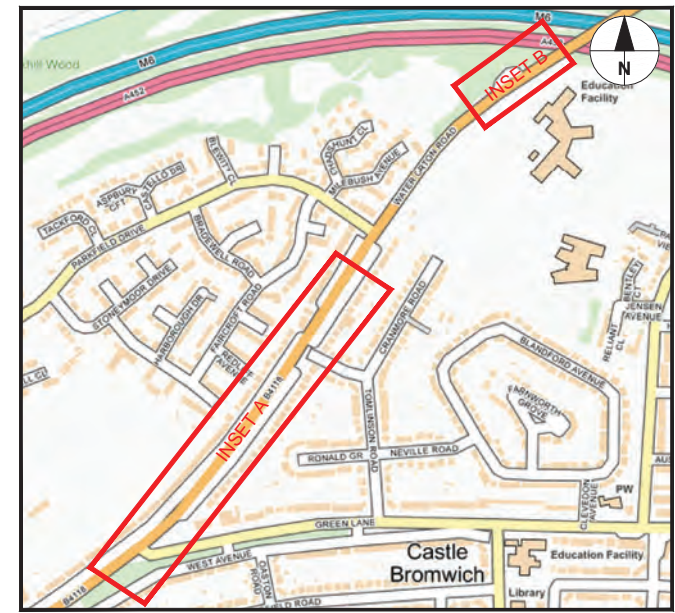

LOCATION PLAN
SCALE (N.T.S)

- Notes
- DO NOT WORK FROM REDUCED DRAWINGS
 - PLEASE REFER TO SCALE AND SIZE SHEET AS INDICATED DIMENSIONS TO BE VERIFIED ON SITE
 - THIS DRAWING SHOULD NOT BE SCALED
 - ANY DISCREPANCIES SHOULD BE REFERRED TO THE ENGINEER PRIOR TO WORK BEING PUT IN HAND
 - ONLY PRINT IN COLOUR
 - ALL ROAD MARKINGS TO BE IN ACCORDANCE WITH THE TRAFFIC SIGNS REGULATIONS AND GENERAL DIRECTIONS (2016) AND THE TRAFFIC SIGNS MANUAL, CHAPTER 5

NOTE: EXISTING SIGNAGE AND LINING TO BE REVIEWED THROUGHOUT

REV	BY	DESCRIPTION	CHECKED	APPROVED	DATE

SOLIHULL MBC LICENSE NO. 100023139
CONTAINS ORDINANCE SURVEY DATA © CROWN COPYRIGHT AND DATABASE RIGHT 2024



Status: **FOR INFORMATION**

Project Title:
WATER ORTON ROAD ROAD SAFETY IMPROVEMENT SCHEME

Drawing Title:
LOCATION & PROPOSALS PLAN

Scale	Date	Drawn-by	Checked-by	Approved-by
As shown	16/05/24	CB	AB	MD

Drawing Number: 236087-SMBC-DR-P-0005