

AREA OF ROLLING TM

DETAIL A

Running lane(s)

Hard Shoulder

Verge

Notes:

- 1) During darkness, a single warning light to BS EN 12352:2006 should be provided.
- 2) Traffic cones should conform to diagram 7101.1 and to BS EN 13422.

DETAIL B

Single/Dual carriageway 40mph or less - 450mm traffic cones, spacing 1.5m.

Single/Dual carriageway 50mph or more - 750mm traffic cones, spacing 1.5m.

Dual carriageway national speed limit - 750mm traffic cones, spacing 1.5m, relaxation 3m.

Notes:

- 1) During darkness, warning lights to BS EN 12352:2006 should be provided in accordance with Table A1.3 (Appendix 1).
- 2) 45° tapers have 1.5m spacing, no relaxations.
- 3) On motorways and NSL AP-duals with hard shoulders, 1m cones will be required for both standard and relaxation works for lead tapers and the facing wall of lane changes.

NOTES:

1. All signs and cones to be in accordance with Chapter 8 new roads and street works a code of practice (Red book)
2. Works access and egress are indicative, exact locations to be agreed on site.
3. Safety zones are to be installed as required as shown by the SAFETY ZONE DIMENSIONS BELOW
4. All signs to be located so as not to obscure signs or objects and should be ballasted near to ground level using sand filled hessian bags or sign straps.
5. All sign positions are indicative only and must be accurately positioned on site with good visibility and be clear of and obstructions or vegetation at all times.
6. Drawing not to scale

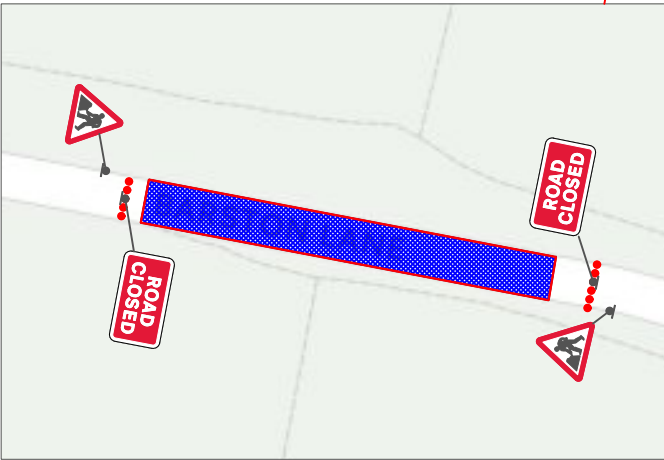
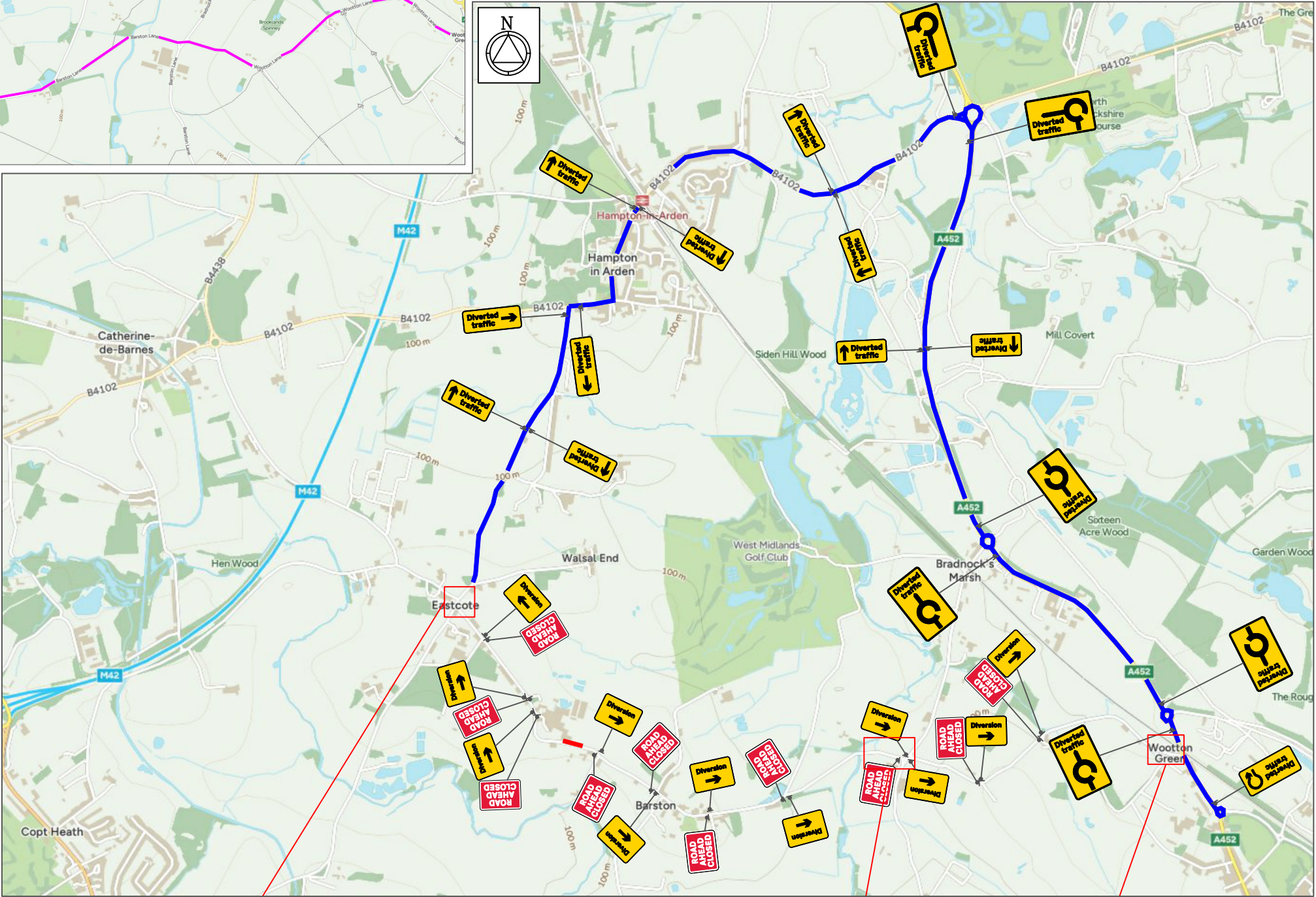

cadrequest@sus.co.uk tmbookings@sus.co.uk

NOTES:

Traffic sign

Cone

Work Area

Safety Zone

Diversion

WORKS ACCESS

WORKS EXIT

Works access/works exit to be risk assessed on site for suitability of location

TRAFFIC MANAGEMENT NOTES

ROAD CLOSURE :

- NOTES
- 1 All traffic signs shall comply with Chapter 8 of the Traffic Signs Manual
 - 2 All traffic management equipment shall be provided by the Contractor, unless otherwise specified.
 - 3 All signs shall be positioned so as not to be obscured by any other objects and shall not obstruct any other sign, permanent or temporary as much as is reasonably practicable.
 - 4 All traffic signs shall meet the reflectorisation requirements of BS 673 : Part 6 : 1983, Table 1.
 - 5 Works Access/Egress to be positioned to suit ongoing works.



SPEED OF ROAD:

LONGWAYS: 0.5m

SIDEWAYS: 0.5m



DIVERSION ROUTE:

A452

B4102

EASTCOTE LANE

A		A	
B		B	
C		C	
D		D	

CLIENT:

SITE:
Barston Ln, Barston, Solihull B92 0JN

GRID REF: -----

TITLE: ROAD CLOSURE

SCALE AT 13: NTS	DATE: XXX	DRAWN: JB	CHECKED: LS
DWG NO: SOL092	REV NO:	001	