

Note:
**Access to be maintained
for vulnerable road users.**

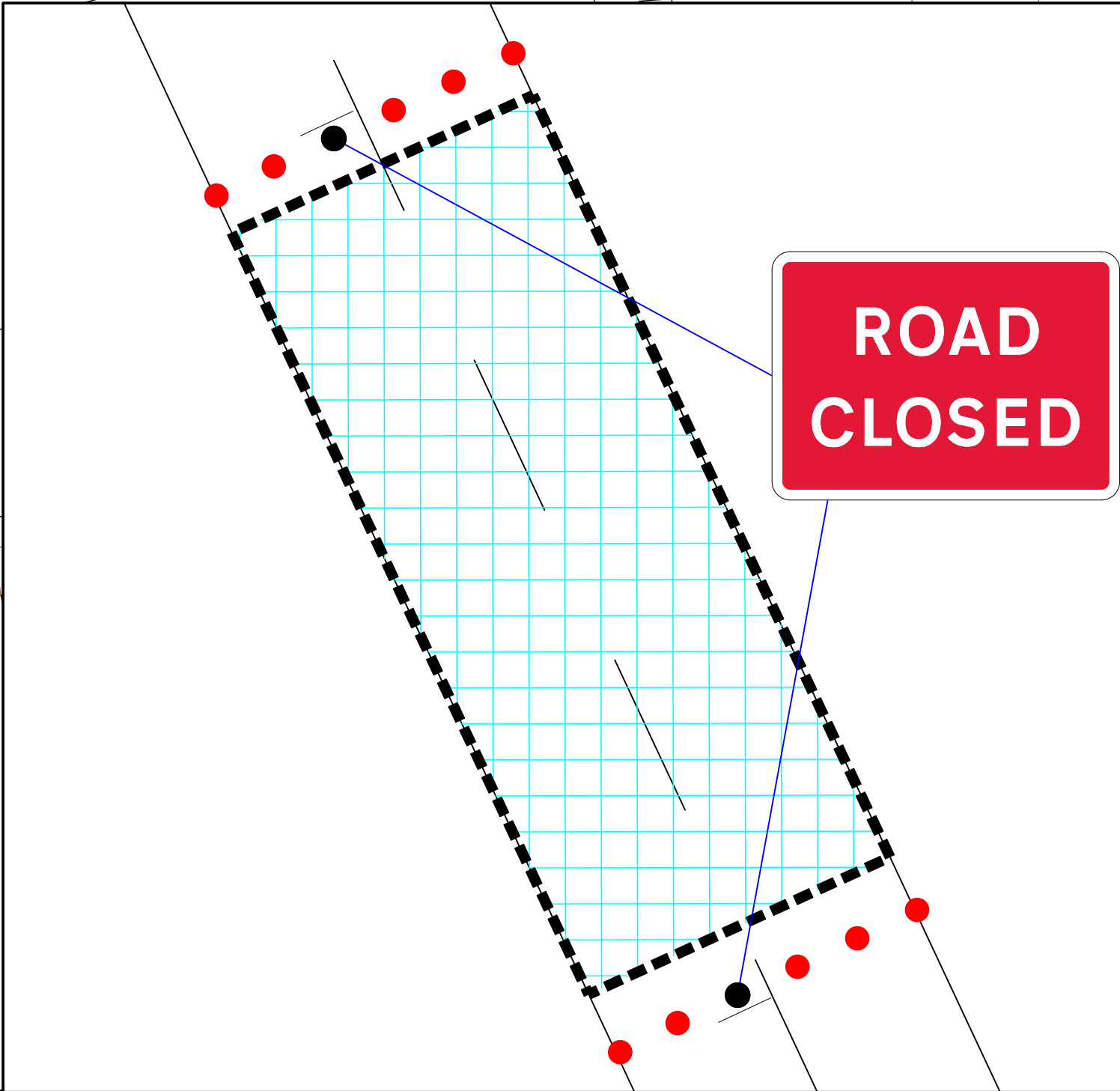

Go Traffic Management

This drawing has been produced for a specific client & project identified below and is not intended for use by any other person or for any other purpose. © Go Traffic Management

Risks

1. Design completed from information provided + google maps desktop risk assessment

2. Cone lamps must be used on all road with A speed limit of 40mph or more.

Notes

1. All signs as per Chapter 8. Distances between cones to be 9m maximum unless otherwise noted.

2. Distances between signs NOT to scale for purpose of clarity.

3. All sign placement subject to available safe working space.

4. The purpose of the Traffic Management Plan is for it to be used only as a guide and all traffic management equipment should be put out according to the 'Safety at Street Works and Road Works - Code of Practice', i.e. Red Book & the 'Traffic Signs Manual Chapter 8', i.e. Yellow Book.

5. Signs must be placed in accordance with TSM and the scheme RAMS pack.

6. Site conditions may have changed since the design of the drawing any changes which subsequently affect the design need to be reported by the Traffic Management Operative & any changes implemented must comply with Chapter 8.

Key

Sign position and aspect of vision

Cones

Barriers

Work Space

Diversion Route 1

Additional Signage Required:

STRATFORD ROAD CLOSED, DIVERSION BELOW TO BE FOLLOWED
STRATFORD ROAD > STRATFORD ROAD

MINIMUM WIDTH OF
SIDEWAYS SAFETY ZONE
MUST BE ADHERED TO 0.5m

MINIMUM WIDTH OF
LONGWAYS SAFETY ZONE
MUST BE ADHERED TO 0.5m

Traffic Management must comply with The Safety at
Street Works and Road Works Code of Practice

ROAD SPEED

30

DO NOT SCALE FROM THIS
DRAWING.

ROAD CLOSURE

B

10/06/2025

DIVERSION AS REQUESTED

A

12/05/2025

AS DRAWN

REV.

DATE

DESCRIPTION

GTM

Go Traffic Management

Head Office: Go Traffic Management,
Chaddock Lane, Worsley, Manchester, M28 1XW

Tel: 0161 351 5370

www.gtm.co.uk

CERTIFIED

R

ISO 9001: ISO 14001
OHSAS 18001

TRAFFIC MANAGEMENT PLAN

Client:

SEVERN

TRENT

WATER

Drawing Number: 1386090.0001

Drawing Title:

Stratford Rd,
Shirley,
Solihull,
B90 4AA

Design:

Technical Officer:

REV:

Name:

J.Carter

L.Whittingham

Signature:

Date:

10/06/2025

10/06/2025

B

BASED UPON THE ORDNANCE SURVEY MAP WITH THE PERMISSION OF THE CONTROLLER OF H.M. STATIONERY OFFICE.