

ISO A1 584mm x 841mm
Drawn: RS
Approved: AC
Checked: PBM
Designer: RS
Project Management: J. Leach
Revision:
Last issued by: GARDINER (2024.05.20) - Last Printed: 2024.05.20
Filename: C:\P\WORKING\AECOM\ISO2_UNCL\TRICHARD GARDINER\AECOM\COM\0434320407222-ACM-HAC-SMBC-DR-TR-2600009

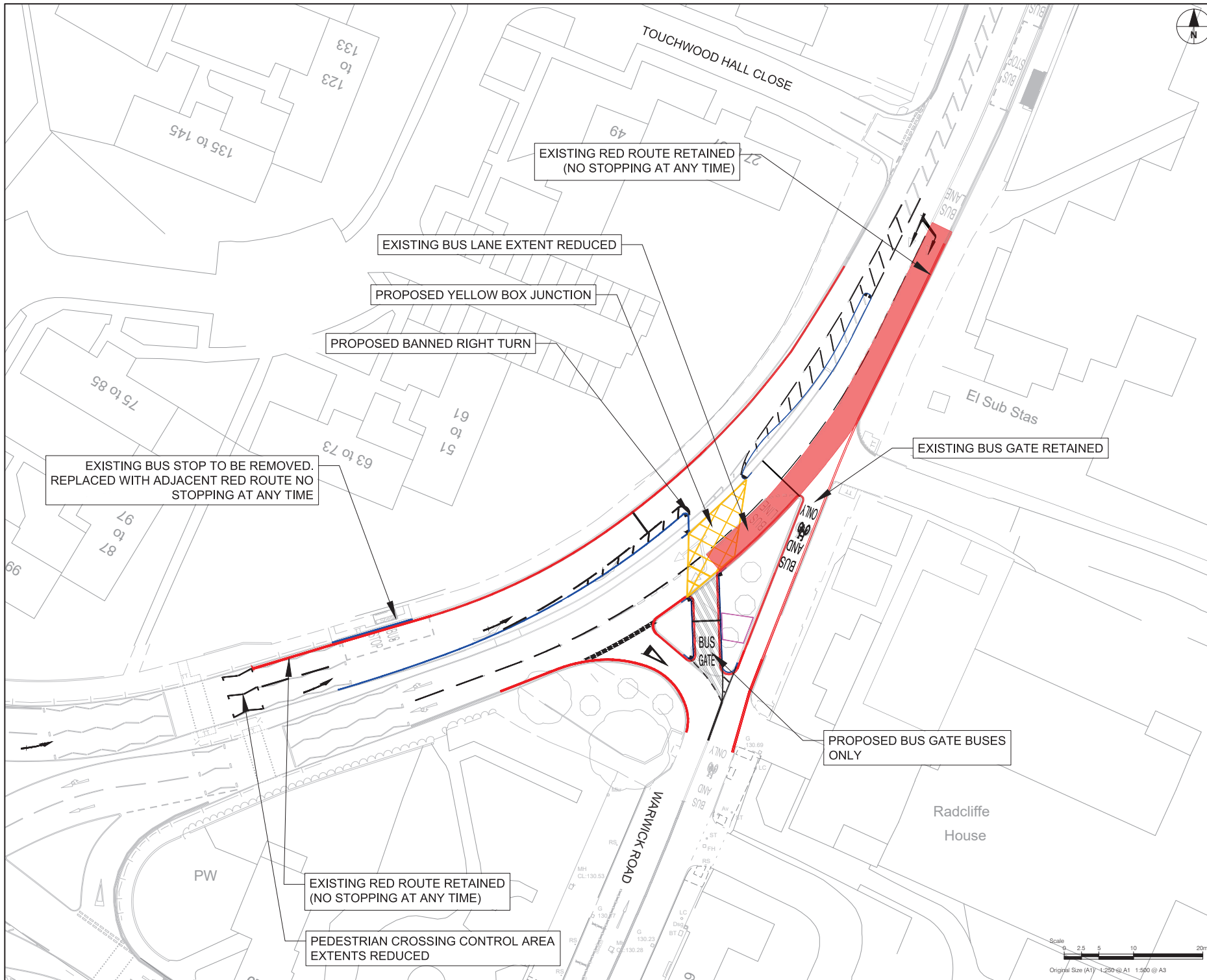

PROJECT
Sprint Phase 2
Package F

CLIENT
Transport for
West Midlands

CONSULTANT
AECOM
The Colmore Building
Colmore Circus Queensway
Birmingham
+44 (0) 121 262 1900
www.aecom.com

REGISTRATION
Reproduced from the Ordnance Survey map with the permission of the controller of H.M. Stationery Office. © Crown copyright reserved. Licence no. 100031673.

NOTES
1. ALL WORKS SHALL BE CARRIED OUT IN ACCORDANCE WITH THE CONTRACT SPECIFICATION AND THE MANUAL OF CONTRACT DOCUMENTS FOR HIGHWAY WORKS INCLUDING REVISIONS/AMENDMENTS AND ANY CLIENT SPECIFIC ADDITIONAL OR SUBSTITUTE CLAUSES.
2. ANY DISCREPANCIES, ERRORS OR OMISSIONS TO BE BROUGHT TO THE ATTENTION OF THE PROJECT MANAGER.
3. ALL DIMENSIONS TO BE CHECKED BEFORE COMMENCEMENT OF WORK ON SITE.
4. ALL DIMENSIONS IN METRES UNLESS OTHERWISE STATED.
KEY

- PROPOSED KERBLINE
- PROPOSED ROAD MARKING
- EXISTING BUS LANE EXTENT REDUCED
- EXISTING ROAD MARKINGS
- PROPOSED BUS LANE
- PROPOSED BUS GATE

UNLESS OTHERWISE STATED
EXISTING RESTRICTIONS WILL
REMAIN

REVISION / APPROVAL DATE	
P04	30/05/24
ISSUE/REVISION	
P01	04/10/23 First Issue
P02	12/01/24 TRO Update
P03	06/03/24 TRO Update
P04	30/05/24 TRO Updates
IR	DATE DESCRIPTION

ISSUE PURPOSE / SUITABILITY
Suitable for review & comment
PROJECT NUMBER
60688007F
SHEET TITLE
PACKAGE F
TRO CONSULTATION PLANS
LODE LANE/
WARWICK ROAD
SHEET NUMBER
Project Number
401222
Location
-ACM
-HAC -
-SMBC -DR -TR -2600 009
Originator
MCHW
Role
Number