

Qty: 1    Ref: 13.9 Schedule 13-9 : Temporary Information	
Qty: 2    Ref: 2702 End of temporary diversion route	
Qty: 1    Ref: 2702 Start of temporary diversion route	
Qty: 1    Ref: 2702 Start of temporary diversion route	
Qty: 2    Ref: 2703 Direction of temporary diversion route from junction ahead	
Qty: 2    Ref: 2703 Direction of temporary diversion route from junction ahead	
Qty: 1    Ref: 2706 Roundabout ahead leading to temporary diversion route	
Qty: 2    Ref: 7010-FP-13-9 Nature of temporary hazard ahead - Road Closed	
Qty: 1    Ref: 7010-FP-13-9 Nature of temporary hazard ahead - Road Ahead Closed	

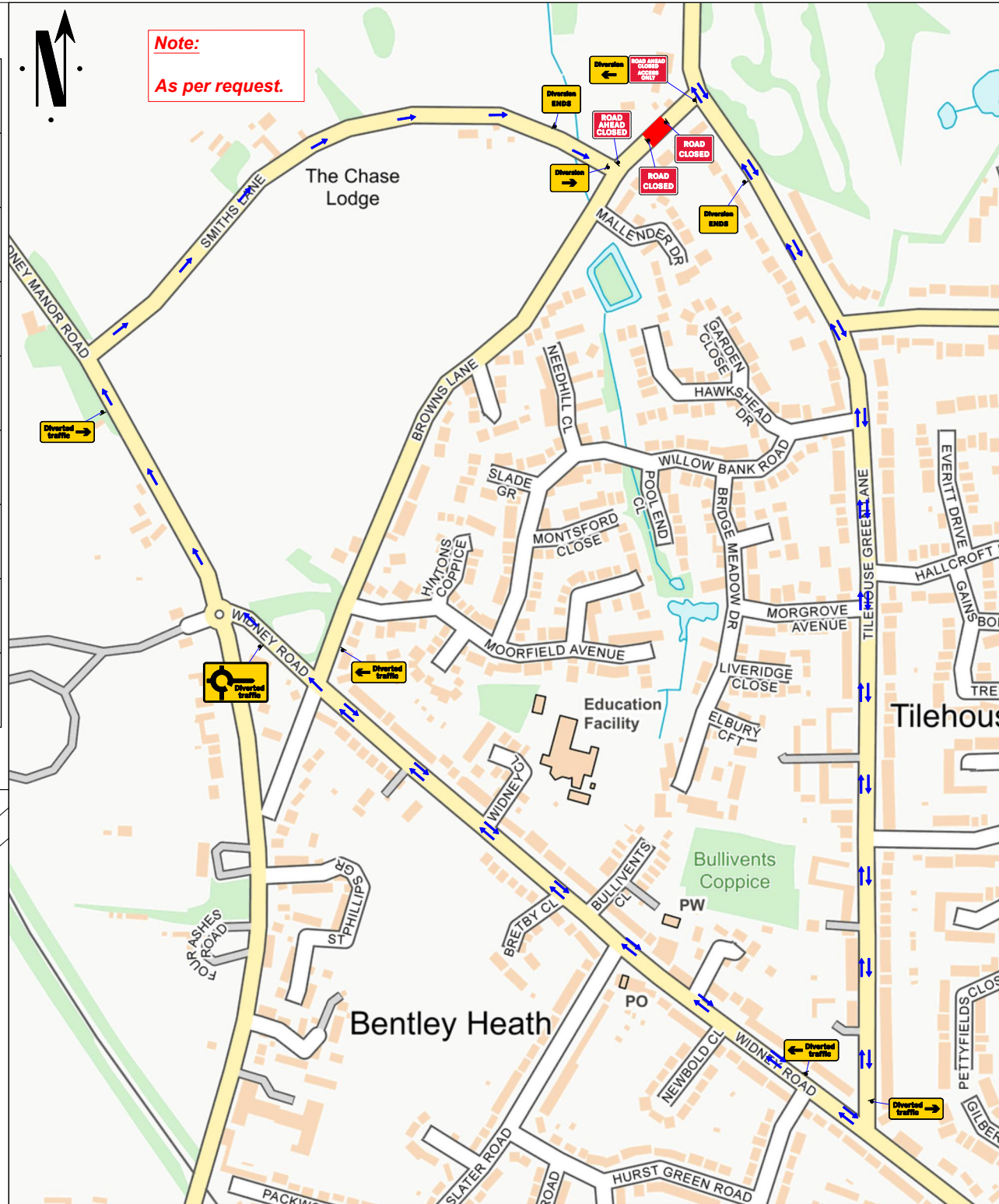
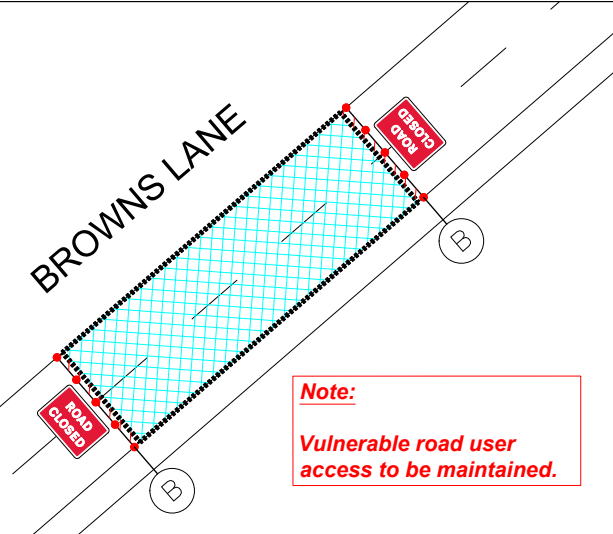

### Go Traffic Management

This drawing has been produced for a specific client & project identified below and is not intended for use by any other person or for any other purpose. © Go Traffic Management

**Risks**

- Design completed from information provided + google maps desktop risk assessment
- Cone lamps must be used on all road with A speed limit of 40mph or more.

**Notes**

- All signs as per Chapter 8. Distances between cones to be 9m maximum unless otherwise noted.
- Distances between signs NOT to scale for purpose of clarity.
- All sign placement subject to available safe working space.
- The purpose of the Traffic Management Plan is for it to be used only as a guide and all traffic management equipment should be put out according to the 'Safety at Street Works and Road Works - Code of Practice', i.e. Red Book & the 'Traffic Signs Manual Chapter 8', i.e. Yellow Book.
- Signs must be placed in accordance with TSM and the scheme RAMS pack.
- Site conditions may have changed since the design of the drawing any changes which subsequently affect the design need to be reported by the Traffic Management Operative & any changes implemented must comply with Chapter 8.

**Key**

	Sign position and aspect of view		Working Space
	Cones		Diversion Route 1

**CLOSED - BROWNS LANE**  
DIVERSION VIA - TILEHOUSE GREEN LANE, WIDNEY ROAD, WIDNEY MANOR ROAD, SMITHS LANE & VICE VERSA

**MINIMUM 0.5M SIDEWAYS & 0.5M LONGWAYS SAFETY ZONE MUST BE ADHERED TO**

**WORK AREA GREATER/LESS THAN 0.5 MILES**

**Traffic Management must comply with The Safety at Street Works and Road Works Code of Practice**

**ROAD SPEED**

**30**

**CROSS SECTION**

DO NOT SCALE FROM THIS DRAWING		ROAD CLOSURE	
A	07/01/26	AS DRAWN	
REV.	DATE	DESCRIPTION	

**GTM**  
**Go Traffic Management**

Head Office: Go Traffic Management,  
Chaddock Lane, Worsley, Manchester, M28 1XW  
Tel: 0161 351 5370  
[www.gtm.co.uk](http://www.gtm.co.uk)

**TRAFFIC MANAGEMENT PLAN**

Client: **SEVERN TRENT WATER**

Drawing Number: 1629059.0001

Drawing Title: 179 Browns Ln, Solihull B93 9BB

Design:	Technical Officer:	REV.
Name: M. Gardiner	SC	A
Signature:		
Date: 07/01/26	07/01/26	