

1st Marston Green Scout Group
GALA DAY PARADE ROUTE 2026

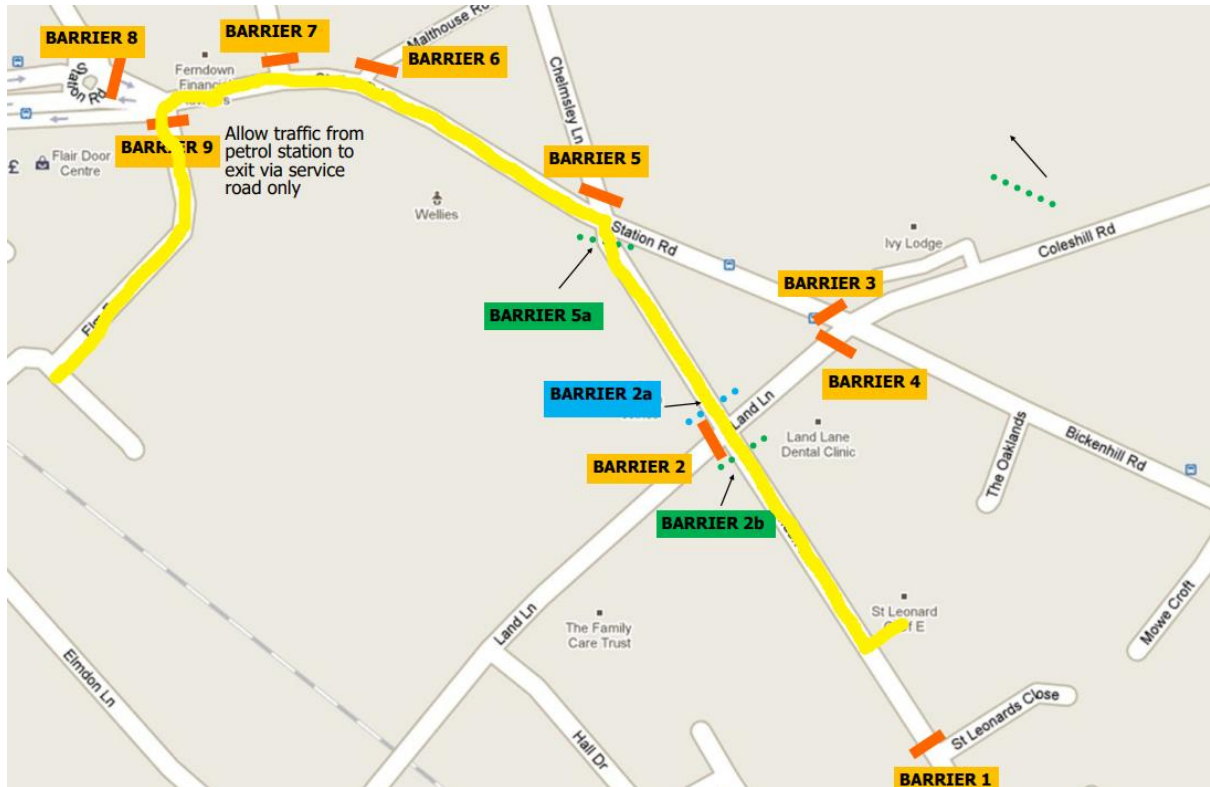

Parade members gather and line up on the lawn at St Leonards church.

Once roads are safely closed, parade along Elm Farm Avenue, turning into Station Road and into Elm Farm Avenue.

Once parade is in Elm Farm Avenue, Barrier 9 remains in place and all other roads are opened to allow traffic through. The parade is held in Elm Farm Avenue for approx. 10 minutes. Once roads are safely re-closed the parade follows the same return back to St Leonards Church lawn.